

# FOR LEASE

Commercial, Industrial &  
Warehouse Facility  
Interstate Frontage & Visibility



Metcalfe & Company, inc.

Adam J. Metcalfe, SIOR  
Post Office Box 2903, Mobile, AL 36652  
(P) 251-432-2600 (C) 251-610-0069  
adam@metcalfec.com www.metcalfec.com

Location: 1854 A E. Interstate 65 Service Road N.  
Mobile, AL  
East side of I-65 Service Road between  
Moffett Road and Highway 45

Suite A

Type: Former truck & trailer repair & warehouse

Size: 41,700± sq ft

6,000± sq ft office/showroom area

2,640± sq ft drive-through service bay

Loading: 3 Dock high, 1 van high and grade level

Lighting: Skylights & new LED

Fire Protection: Fully sprinkled

Eave Height: 18' ±

Signage: Dual-pole signage available



Site: 4± acres  
Paved Frontage Display Area  
Additional land available

Zoning: I-1, Light Industrial  
City of Mobile

Availability: All or part

Rental Rate: \$6.00 psf, Net Net

The information provided for by the company is subject to errors, omissions, changes, prior sale or lease and withdrawal from the market without notice by the owner. This information has been gathered from sources that are deemed to be reliable, however there is no warranty or guarantee to its accuracy or validity. You are hereby advised to independently verify the information presented herein.

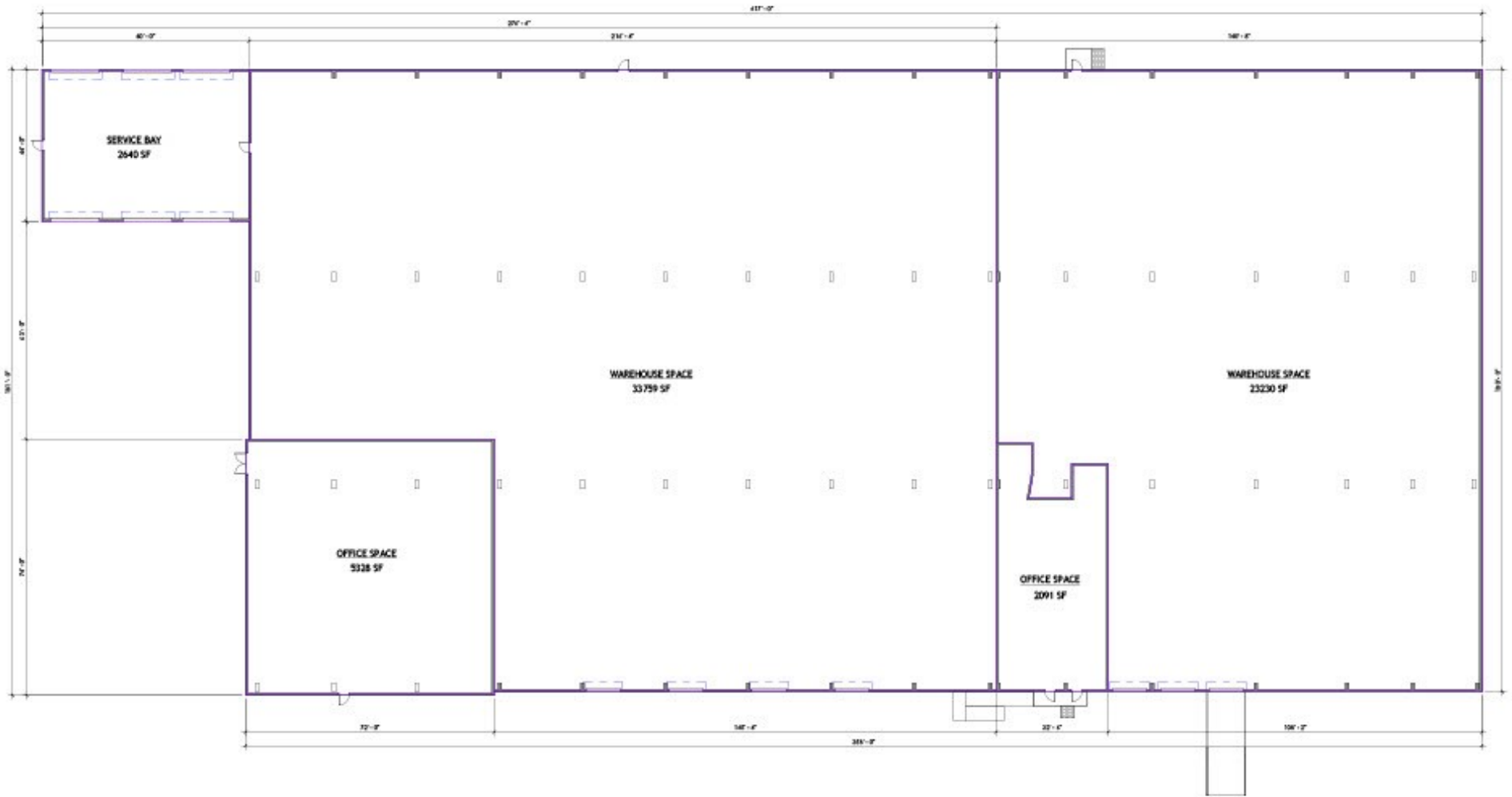

The information provided for by the company is subject to errors, omissions, changes, prior sale or lease and withdrawal from the market without notice by the owner. This information has been gathered from sources that are deemed to be reliable, however there is no warranty or guarantee to its accuracy or validity. You are hereby advised to independently verify the information presented herein.